

State Well Report

Part 1

Mississippi Department of Environmental Quality
Office of Land and Water Resources
P.O. Box 10631
Jackson, MS 39289-0631
(601)961-5210
(601)354-6938 (fax)

County: Desoto
 Permit #: _____
 Driller: Jones w. Mason
 Date drilling completed: 9-30-04

For Office Use Only:

Aquifer: _____
 Well #: F-128
 L. S. Elevation: _____
 E-log #: _____

State Law requires that this report be prepared by the driller in detail and filed with the Department within 30 days of completion of drilling of the well.

Well Owner Information	Well Location
Owner Name: <u>Louise Kellpatrick</u>	Latitude: <u>34° 54' 33³⁸"</u> Longitude: <u>90° 02' 29²⁸"</u>
Mailing Address: <u>3400 Sherrod Lane</u>	Method of Lat/Long (circle one): Conventional Survey, <u>Hand-held GPS</u>
<u>Nesbit</u> <u>MS</u> <u>38651</u>	USGS quad, <u>Hand-held GPS</u> , Survey-grade GPS
City State Zip Code	<u>NE</u> ¼ <u>SE</u> ¼ Sec <u>16</u> Twn <u>25</u> Rng <u>8W</u>
Telephone No. <u>(601) 826-4818</u>	Distance Direction Nearest Town <u>2</u> Miles <u>NW</u> of <u>Nesbit</u>

Well Data

Purpose of Well (circle one) Home Industrial Public Supply Irrigation Fish Culture Other: _____

Date well drilling started: 9-30-04 Date well drilling completed: 9-30-04

If flowing, method of flow regulation: Valve NA Other (describe) _____

Static Water Level: 110' feet above or below (circle one) land surface Date measured: 9-30-04

Method of Measurement (circle one) steel tape electric tape air line other: string/weight

Hole depth: 168' Well depth: 168' Well grouted to a depth of 10 feet

Type of grout (circle one): Cement Bentonite Mix

Casing length: 148' feet Casing diameter: 4 inches Type of casing: PUC

Screen length: 20 feet Screen diameter: 4 inches Type of screen: PUC

Screen slot size: .010 inches Setting depth: From 148 feet to 168 feet

Type of completion (circle all applicable): Gravel packed Underreamed Telescoped Open hole Natural Development

Other (describe): _____

Top of lap pipe or reduction in casing: NA feet. If telescoped or more than one screen, describe on back of page

Logs run (circle all applicable): No log run Electric Gamma Ray Density Sonic Neutron Other: _____

Name of organization running log(s): _____

I certify that the well was drilled, constructed, and completed in accordance with all applicable requirements of the Mississippi Department of Environmental Quality and/or the Mississippi Department of Health regulations and state laws.

Jones w. Mason 0-620
 Print Name of Water Well Contractor and License No.

Jones w. Mason
 Signature of Water Well Contractor

RECEIVED
OCT 18 2004
BY: OLWR

If well telescopes please sketch below and show depths.

Ground Level

F-128

Description of Formations Encountered	From	To
clay dirt	0	22
gravel	22	35
Blue clay	35	50
Gravel	50	70
Blue clay	70	105
white sand	105	168

If more than one screen, show location of each on sketch

Sketch the property layout and include the following: 1) the well location; 2) any permanent structures on the property that may aid in locating the well; 3) any roads, power lines, or other items that may aid in locating the property and the well; 4) indicate direction.

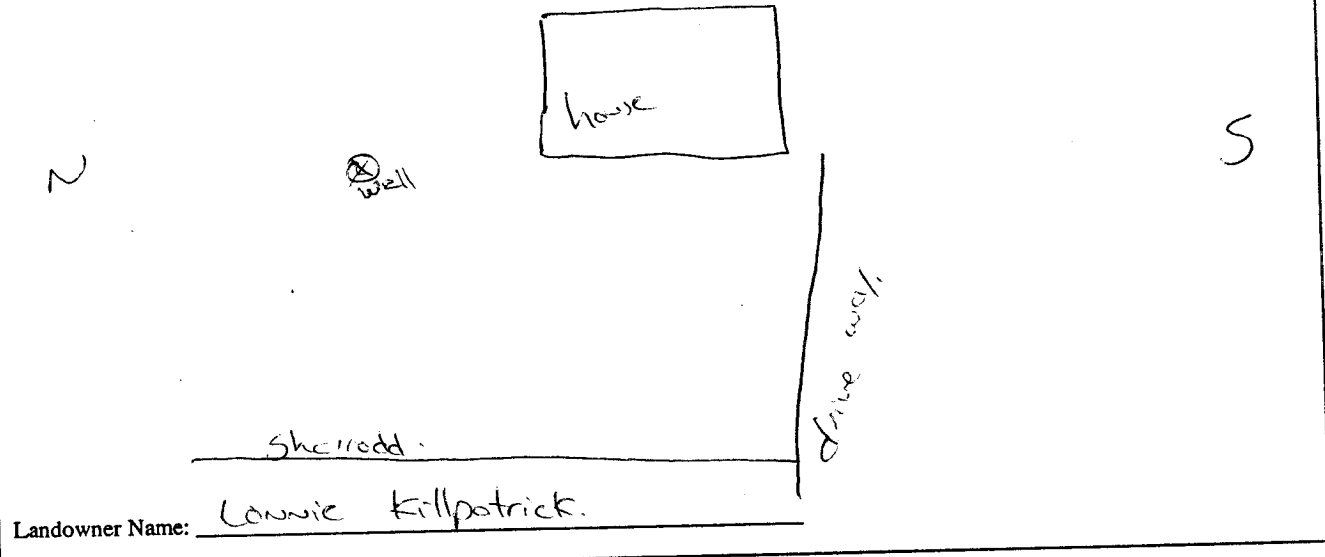

Landowner Name: Lonnie Killpatrick.

[Signature]
Signature of Water Well Contractor

STATE WELL REPORT

Part 2

Pump Installer's Completion Report
 Mississippi Department of Environmental Quality
 Office of Land and Water Resources
 P.O. Box 10631
 Jackson, MS 39289-0631
 (601)961-5210
 (601)354-6938 (fax)

County: Desoto
 Permit #: _____
 Driller: Jones W. Massey
 Date completed: 10-1-04

For Office Use Only:

Aquifer: _____
 Well #: F-128
 Elevation: _____

This report should be prepared by the pump installer in detail and filed with the Department within 30 days of the installation of pump.

Well Owner Information	Well Location
Owner Name: <u>Lorrie Killpatrick</u>	Latitude: <u>34.54-623</u> Longitude: <u>90-02-797</u>
Mailing Address: <u>3400 Shiered Lane</u>	Method of Lat/Long (circle one): Conventional Survey,
<u>Nesbit</u> <u>MS</u> <u>38651</u>	USGS quad, (<u>Hand-held GPS</u>) Survey-grade GPS
City State Zip Code	<u>NE</u> 1/4 <u>SE</u> 1/4 Sec <u>16</u> Twn <u>25</u> Rng <u>8W</u>
Telephone No. (<u>901</u>) <u>826-4218</u>	Distance Direction Nearest Town
	<u>2</u> Miles <u>NW</u> of <u>Nesbit</u>

Pump Type Circle one	Power Type Circle one
Air Lift Jet <input type="radio"/> <u>Submersible</u> <input type="radio"/>	Diesel Engine Gasoline Engine Natural Gas
Bucket Piston <input type="radio"/> Turbine <input type="radio"/>	<u>Electric Motor</u> <input type="radio"/> Hand <input type="radio"/> Tractor PTO
Centrifugal Rotary <input type="radio"/> Flowing Well <input type="radio"/>	Windmill Other (specify): _____
Other (specify): _____	Horse Power Rating of Motor: <u>2hp</u>
Date Pump Installed: <u>10-1-04</u>	Setting Depth: <u>140'</u> feet
Rated Pump Capacity: <u>28</u> Gallons Per Minute	Number of Stages: <u>14</u>

Pump Test Data	Method of Measuring Water Level Circle one
Date Well Tested: <u>10-1-04</u>	Air Line Electric Measuring Line Steel Tape
Static Water Level (A): <u>110'</u> Feet Below Land Surface	Other (specify): <u>string weight</u>
Pumping Water Level (B): <u>NA</u> Feet Below Land Surface	For flowing well, measured shut in head: <u>NA</u> feet
Drawdown [(B) - (A)]: <u>NA</u> Feet Below Land Surface	Well yielded <u>37</u> GPM with a drawdown of
Test Pumping Rate: <u>37</u> Gallons Per Minute	<u>NA</u> feet after <u>24</u> hours of pumping
Duration of Pump Test (minimum 4 hours): <u>24</u> hours	

I HEREBY CERTIFY that the above statements are true to the best of my knowledge.

Jones W. Massey Jones W. Massey
 Print Name of Pump Installer and License No. (if applicable) Signature of Pump Installer

RECEIVED
 OCT 18 2004
 BY: OLWR